



NEW

BLÜCHER® System-X transition adaptor

The easy transition coupling connection
to other steel piping systems

- Fits many systems
- Fast installation
- Vacuum and gravity
- For refurbishment



Read more:
blucher-marine.com

BLÜCHER®

A WATTS Brand

BLÜCHER® System-X transition adaptor

- The easy transition coupling connection to other steel piping systems

These new adaptors can be used to connect the BLÜCHER® EuroPipe system with other steel/ stainless steel piping systems made according to the standard EN1124-3 (System X).

It is especially for refurbishment projects these adapters may be needed, when replacing old pipe systems (e.g. black water, gray water or outside drainage systems). This is the ideal solution as the jointing still is a push-fit solution, which gives a much faster installation time compared to a coupling solution or a welded solution.

As simple as that ...



BENEFITS:

- The BLÜCHER® EuroPipe system can easily be connected to other pipe systems by using System-X transition adaptor.
- Fast installation due to push-fit connection
- Both for vacuum and gravity systems
- Ideal for refurbishment/refit projects
- Material AISI 316L

SYSTEM-X TRANSITION ADAPTOR WITH BLÜCHER SOCKET / SYSTEM X SPIGOT

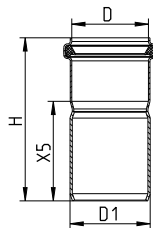
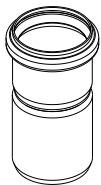

Type no.	D	D1	H	X5
859.040.042 S	Ø40	Ø42.4	87	45
859.050.053 S	Ø50	Ø53	108	66
859.075.073 S	Ø75	Ø73	135	85
859.110.102 S	Ø110	Ø101.6	150	93

SYSTEM-X TRANSITION ADAPTOR WITH BLÜCHER SPIGOT / SYSTEM X SOCKET

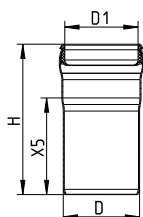
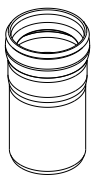

Type no.	D	D1	H	X5
859.053.050 S	Ø50	Ø53	110	65
859.073.075 S	Ø75	Ø73	148	95
859.102.110 S	Ø110	Ø101.6	175	110

BLÜCHER®

Pugdølvej 1 • 7480 Vildbjerg • Tel.: +45 99 92 08 00
marine@blucher.com • www.blucher-marine.com

BLÜCHER®

A WATTS Brand